

1 inch = 290.17 feet

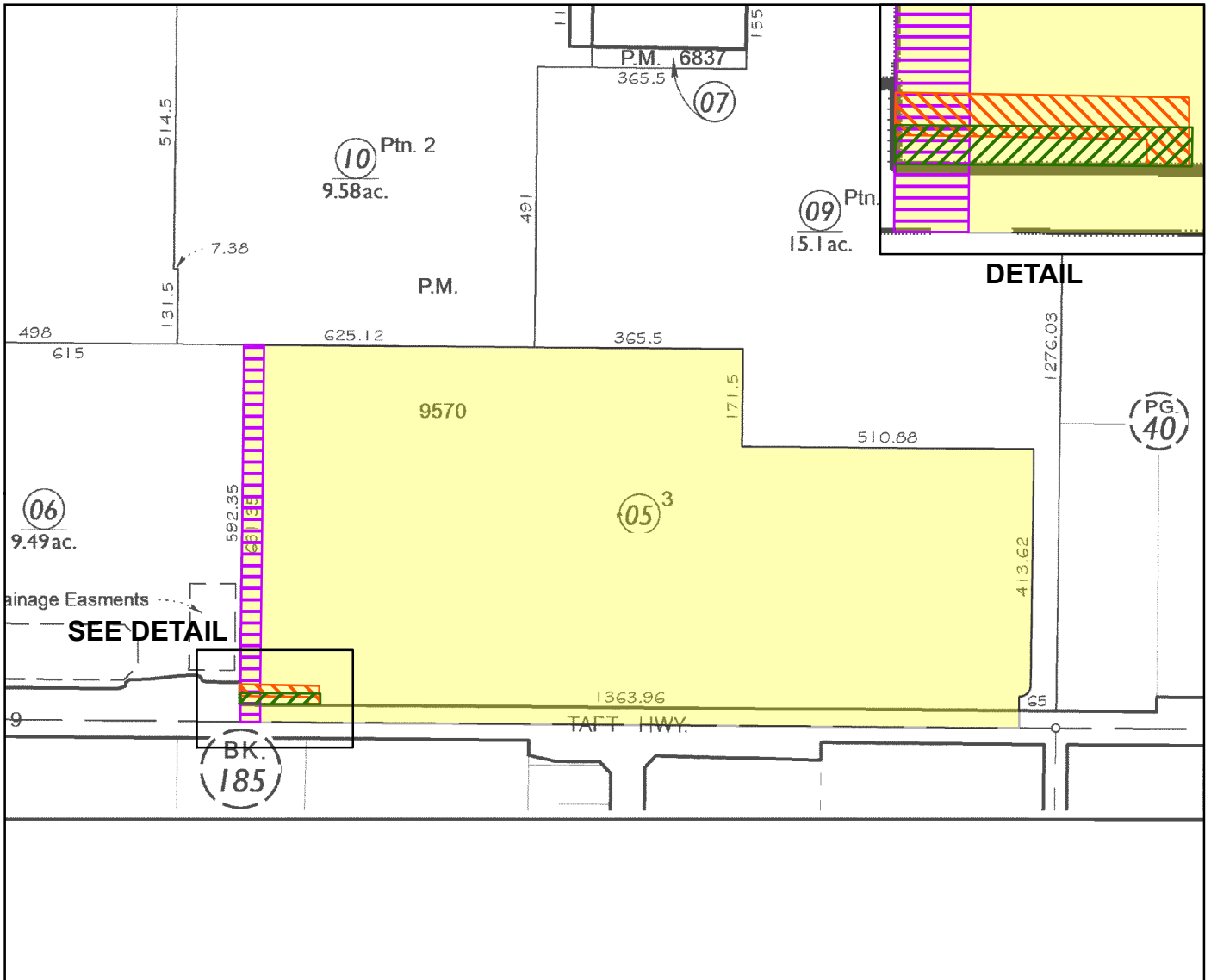

Legend

- Property In Question - Fee
- Item No. 10 - Easement for Sewer
In 12/01/1994 Inst # 0194171628 of Official Records
Affects said portion as described in the document
- Item No. 11 - Easement for Sewer
In 10/19/1997 Inst # 0197107695 of Official Records
Affects said portion as described in the document
- Item No. 13 - Easement for Right of Way, Ingress & Egress
In 12/23/2003 Inst # 0203276586 of Official Records
Affects said portion as described in the document

<p>©2026 Ticor Title Company 2540 W. Shaw Lane, Suite 112 Fresno, CA 93711</p>	<p>Title Order No. : FTKE-3012600996, Preliminary Report Dated April 24, 2026</p> <p>Reference :</p> <p>Property : Vacant Land, Bakersfield, CA</p>	<p>Drawing Date : 05/14/2026 - FNFI</p> <p>Assessor's Parcel No. : 517-030-05-00</p> <p>Data :</p>
<p>This map/plat is being furnished as an aid in locating the herein described Land in relation to adjoining streets, natural boundaries and other land, and is not a survey of the land depicted. Except to the extent a policy of title insurance is expressly modified by endorsement, if any, the Company does not insure dimensions, distances, location of easements, acreage or other matters shown thereon.</p>		<p>Plat Showing : PARCEL 3 OF PARCEL MAP 9570 IN THE UNINCORPORATED AREA, COUNTY OF KERN, STATE OF CALIFORNIA, AS PER MAP RECORDED OCTOBER 16, 1992 IN BOOK 44, PAGES 127 OF MAPS IN THE OFFICE OF THE COUNTY RECORDER OF SAID COUNTY.</p>
		<p>Sheet 2 of 2</p> <p>Archieve #</p>